

## AS70-B-153 - SPEEDLINE System Data Sheet - Version V1 (24-10-23)

SPEEDLINE 70mm Acoustic 'C' Stud Partition  
 @600mm Ctrs, with BG Gyproc 12.5mm  
 SoundBloc each side

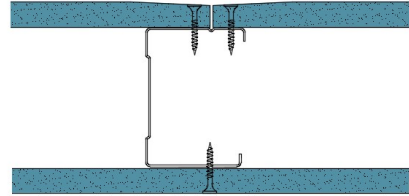

### System Performance Breakdown

Fire Resistance:

BS476 Part 22:1987:

Test Ref & Date or Applied Ref & Report:

Max Height:

Thickness:

Duty Grade: BS 5234: Part 2:1992:

Sound Insulation:

**30/30 Minutes** (Integrity/Insulation).

**BTC 17439F - BRE Report P102396-1011A**

**Refer to Speedline Specification Clause**

**97 mm.** (At Base Track, Excluding Finishes)

**Medium - Annexes A-F**

**42  $R_w$ dB**, Date Tested or Assessed Against - 01/07/2010

Test Code:  
H16909GA  
Test Date:  
01/07/2010

Freq. Hz	R dB
50	18.9
63	10.5
80	7.1
100	11.5
125	19.1
160	27.1
200	34.0
250	36.2
315	34.7
400	39.5
500	45.7
630	48.5
800	53.8
1 000	56.5
1 250	58.6
1 600	61.6
2 000	61.1
2 500	54.5
3 150	43.9
4 000	44.2
5 000	47.7
6 300	
8 000	
10 000	

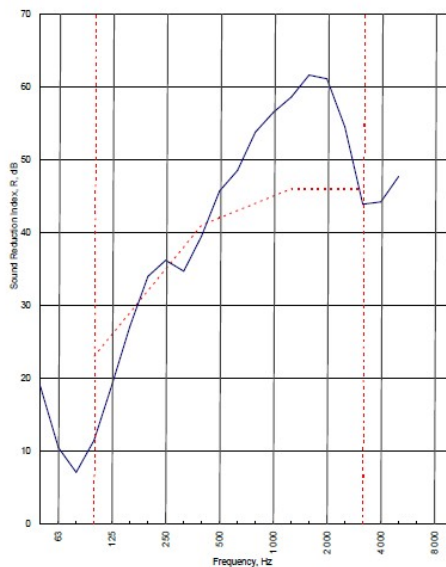



Rating according to BS EN ISO 717-1:1997  
 **$R_w$  (C;Ctr) = 42 (-4;-12) dB**  
 Max dev. 11.5 dB at 100 Hz  
 Evaluation based on laboratory measurement results obtained by an engineering method.  
 $C_{50-3150} = -6$  dB     $C_{50-2000} = -6$  dB     $C_{100-5000} = -3$  dB  
 $C_{10-50-3150} = -17$  dB     $C_{10-50-2000} = -17$  dB     $C_{10-100-5000} = -12$  dB

TESTED AT ONE OF THE UKAS ACCREDITED LABORATORIES BELOW

B.T.C (H-Ref on Graph) 

B.R.E 

AIRO 

S.R.L 

Customer: Metsec plc Hepsec Division



BTC 16962A: Page 8 of 10

SPEEDLINE Drywall Systems, Adsetts House, 16 Europa View, Sheffield Business Park, Sheffield, S9 1XH.

Tel: 0114 231 8030.

Email: [enquiries@speedlinedrywall.co.uk](mailto:enquiries@speedlinedrywall.co.uk)

(As per the requirements set out in ISO/IEC 17025:2017 regarding test data the results stated have been carried out by voestalpine Metsec plc as part of the contract to supply Speedline Metal Sections to SIG Plc)